

KEY TO PAVEMENT FINISHES:

ASPHALT FINISH (25mm/30mm FINISH)

CONCRETE INTERLOCKING PAVING
FINISH (60mm or 80mm THICK)

CONCRETE SURFACE BED (200mm THICK)

FOR LAYERWORK DETAILS, PLEASE REFER
TO DWG B02-PZB-000084-40

GENERAL NOTES

- All dimensions and levels to be checked on site and correlated with architects drawings and details before construction commences and any discrepancies are to be reported immediately to the architect and engineer.
- All waterproofing details are to be in accordance with the architects specifications and instructions.
- All details and dimensions shown on these drawings are subject to confirmation on site and during construction.
- All construction methods and materials used are to be in accordance with the requirements of SANS 10400, (i) SANS1200 A (1986): General, (ii) SANS1200 AA (1986): Small works, (iii) SANS1200 D (1986): Earthworks
- It is the contractor's responsibility to ensure that he understands and complies with all relevant engineering drawings and specifications and is adequately experienced to undertake all aspects of the work safely.
- All details and dimensions pertaining to any existing structures are to be confirmed on site by the contractor and the engineer is to be immediately informed of any unexpected aspects pertaining to them.
- All products specified for use are to be used strictly according to manufacturer's instructions and specifications at all times.
- The contractor is at all times to be fully responsible for quality control on site ensuring strict compliance with all drawings, details and specifications issued for construction by the professional team.
- The contractor is to comply at all times with all relevant municipal regulations and bylaws in the area of the site and is to ensure that he has a set of approved building plans on site at all times.
- Sealing compounds for the building & construction industry to be in accordance with the requirements of SANS11077 (1984) sealing compounds for the building and construction industry, two component, polyurethane-base and SIKAPRO 2HP universal one component polyurethane joint sealant or similar approved may be used on all wall joints and must be applied strictly to the manufacturer's specifications and the correct backing cord should be used where necessary.
- The contractor shall provide results of compaction testing of the earthworks layers for approval, if requested by the engineer, before casting surface beds. A minimum requirement is at least 100mm of approved hard-core or 300mm of approved granular fill compacted to a minimum of 98% Mod. AASHTO.
- No DPC below external surface beds and handstands. Top of surface bed level to be a minimum of 150mm above the final outside levels as per SANS10400.

STORMWATER RETICULATION NOTES

- THIS DRAWING TO BE READ IN CONJUNCTION WITH ARCHITECTS DRAWINGS.
- NEW 450mmØ HD uPVC STORMWATER PIPES
- 1m MIN. FROM BUILDING
- DIMENSIONS MUST NOT BE SCALED OR ASSUMED
- ALL STORMWATER PIPES RUNNING UNDER THE BUILDING TO BE ENCASED IN MASS CONCRETE

☒ ALL STORMWATER MANHOLES IN ROAD AREA TO HAVE A HEAVY DUTY SLOTTED COVER AND FRAME
RE RODDING EYE

COPY RIGHT RESERVED

THE DUPLICATION OF THIS DRAWING IS STRICTLY PROHIBITED.



30 MONTROSE PARK BLV.
VICTORIAN COUNTRY CLUB ESTATE
MONTROSE
3200

P.O. BOX 1066
PIETERMARITZBURG
3200

TEL: 033-328 1000
FAX: 033-328 1005
e-mail: pietermaritzburg@rhdhv.com

CLIENT:



PROJECT:

SARS PIER 1 STATE WAREHOUSE
SITE PLAN WITH CIVILS LAYOUT

PURPOSE OF ISSUE:

ISSUED FOR CONSTRUCTION

DRAWING DESCRIPTION:

EXTERNAL WORKS:
STORMWATER SERVICES
AND PAVEMENT LAYOUT

DESIGNED BY:

S. JAMALI

SIGNATURE AND DATE:

DESIGN CHECKED BY:

F. KAMBA

SIGNATURE AND DATE:

DRAWN BY:

S. JAMALI

SIGNATURE AND DATE:

DRAWING CHECKED BY:

F. KAMBA

SIGNATURE AND DATE:

ENGINEERS FINAL APPROVAL:

F. KAMBA

SIGNATURE AND DATE:

PROJECT NUMBER:

B02.PZB.000084

PAPER SIZE:

A1

SHEET NUMBER:

SHEET 1 OF 1

SCALE FACTORS:

AS SHOWN

REVISION INFORMATION

NO	DATE ISSUED	CHANGED	DESCRIPTION OF CHANGE	APPROVED
0	17.06.2016	SJ	ISSUED FOR CONSTRUCTION	FK
1	11.11.2016	SJ	FOR COSTING/APPROVAL	FK
2	05.12.2016	SJ	DETAILS MOVED TO DWG -40; GENERAL DRAWING UPDATES	FK

B02-PZB-000084-10

REV 2

ISSUED FOR CONSTRUCTION

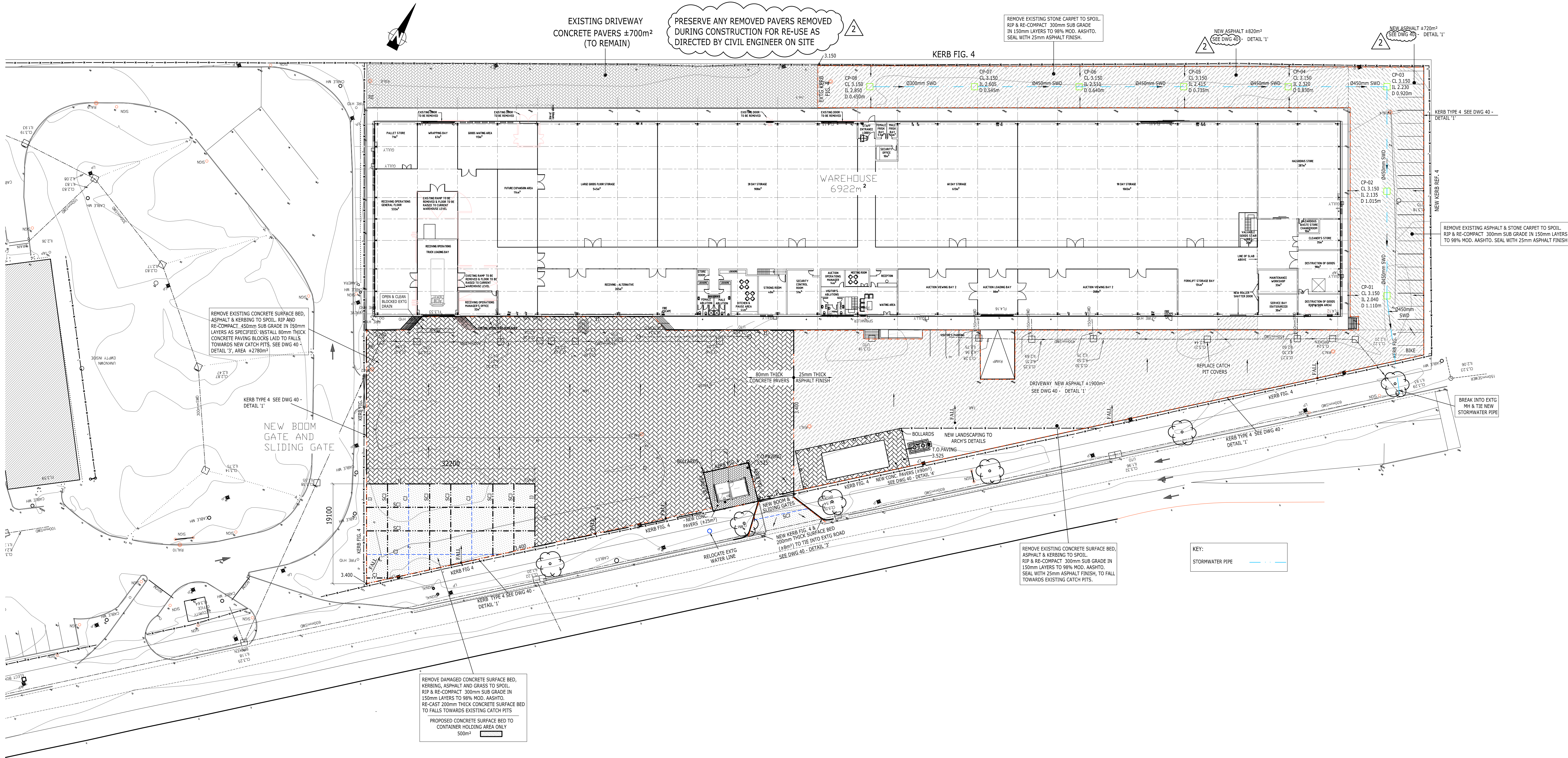

SITE PLAN WITH STORMWATER SERVICES AND PAVEMENT LAYOUT

1 : 500