

1. FOR TYPICAL WATER DETAILS, PLEASE REFER TO DWG B02.PZB.000084-21.
2. READ THIS DRAWING TOGETHER WITH ALL RELEVANT FIRE ENGINEER'S DRAWINGS.

WATER RETICULATION NOTES

- 500, 320 & 200 HDPE CLASS 12 WATER PIPE
- B = 90° BEND
- T = TEE PIECE
- BOX VALVE (200, 320, 500 & 1100)

FIRE MAIN NOTES

- WATER PIPE TO BE 1100 HDPE CLASS 10 PIPE OR SIMILAR APPROVED
- FHR = FIRE HOSE REEL
- FE = FIRE EXTINGUISHER (4.5kg DCP)
- (TO COMPLY WITH FIRE ENGINEER'S DETAILS)

GENERAL NOTES

- All dimensions and levels to be checked on site and correlated with architects drawings and details before construction commences and any discrepancies are to be reported immediately to the architect and engineer.
- All waterproofing details are to be in accordance with the architects specifications and instructions.
- All details and dimensions shown on these drawings are subject to confirmation on site and during construction.
- All construction methods and materials used are to be in accordance with the requirements of SANS 10400, (i) SANS1200 A (1986): General, (ii) SANS1200 AA (1986): Small works, (iii) SANS1200 D (1986): Earthworks
- It is the contractor's responsibility to ensure that he understands and complies with all relevant engineering drawings and specifications and is adequately experienced to undertake all aspects of the work safely.
- All details and dimensions pertaining to any existing structures are to be confirmed on site by the contractor and the engineer is to be immediately informed of any unexpected aspects pertaining to them.
- All products specified for use are to be used strictly according to manufacturer's instructions and specifications at all times.
- The contractor is at all times to be fully responsible for quality control on site ensuring strict compliance with all drawings, details and specifications issued for construction by the professional team.
- The contractor is to comply at all times with all relevant municipal regulations and bylaws in the area of the site and is to ensure that he has a set of approved building plans on site at all times.
- Sealing compounds for the building & construction industry to be in accordance with the requirements of SANS11077 (1984) sealing compounds for the building and construction industry, two component, polyurethane-base and Sika-PRO 2HP universal one component polyurethane joint sealant or similar approved may be used on all wall joints and must be applied strictly to the manufacturer's specifications and the correct backing cord should be used where necessary.
- The contractor shall provide results of compaction testing of the earthworks layers for approval, if requested by the engineer, before casting surface beds. A minimum requirement is at least 100mm of approved hard-core or 300mm of approved granular fill compacted to a minimum of 98% Mod. AASHTO.
- No DPC below external surface beds and hardstands. Top of surface bed level to be a minimum of 150mm above the final outside levels as per SANS10400.

NOTES:

COPY RIGHT RESERVED

THE DUPLICATION OF THIS DRAWING IS STRICTLY PROHIBITED.



30 MONTROSE PARK BLV,
VICTORIAL COUNTRY CLUB ESTATE
MONTROSE
3200

P.O. BOX 1066
PIETERMARITZBURG
3200

TEL: 033-328 1000
FAX: 033-328 1005
e-mail: pietermaritzburg@rhdhv.com

CLIENT:



PROJECT:

SARS PIER 1 STATE WAREHOUSE
SITE PLAN WITH CIVILS LAYOUT

PURPOSE OF ISSUE:

ISSUED FOR CONSTRUCTION

DRAWING DESCRIPTION:

EXTERNAL WORKS:
POTABLE AND FIRE WATER
RETICULATION LAYOUT & DETAILS

DESIGNED BY: S. JAMALI	SIGNATURE AND DATE:
DESIGN CHECKED BY: F. KAMBA	SIGNATURE AND DATE:
DRAWN BY: S. JAMALI	SIGNATURE AND DATE:
DRAWING CHECKED BY: F. KAMBA	SIGNATURE AND DATE:
ENGINEERS FINAL APPROVAL: F. KAMBA	SIGNATURE AND DATE:

PROJECT NUMBER: B02.PZB.000084	PAPER SIZE: A1
SHEET NUMBER: SHEET 1 OF 1	SCALE FACTORS: AS SHOWN

REVISION INFORMATION

NO	DATE ISSUED	CHANGED	DESCRIPTION OF CHANGE	APPROVED
0	17.06.2016	SJ	ISSUED FOR CONSTRUCTION	FK
1	05.12.2016	SJ	RE-ISSUED FOR CONSTRUCTION	FK
2	02.02.2017	SJ	DOMESTIC & FIRE WATER RETICULATION LAYOUT AMPLIFIED	FK

ISSUED FOR CONSTRUCTION

B02-PZB-000084-20

REV 2

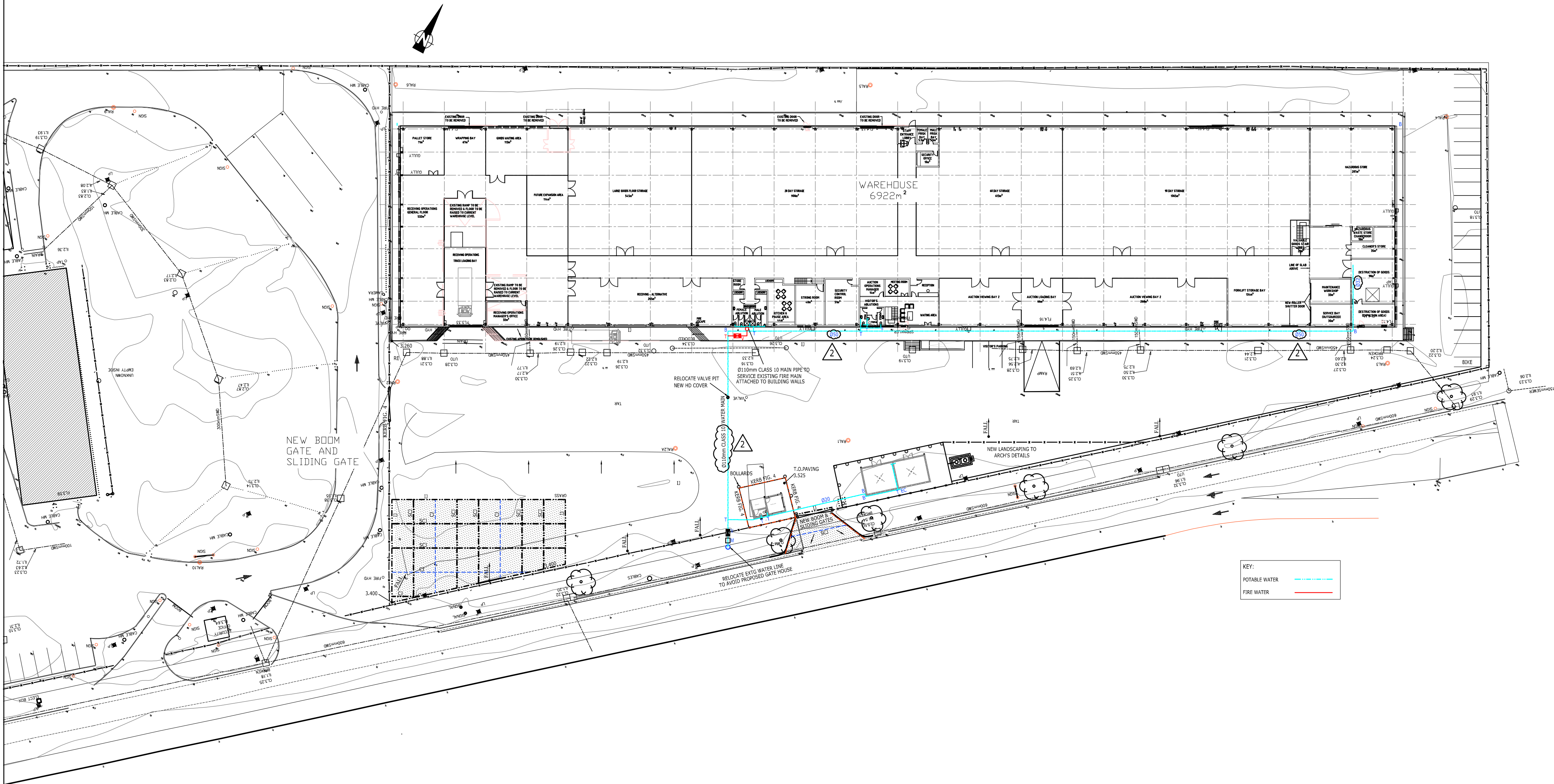

SITE PLAN WITH POTABLE AND FIRE WATER RETICULATION
1 : 500